

RAFT FOUNDATION

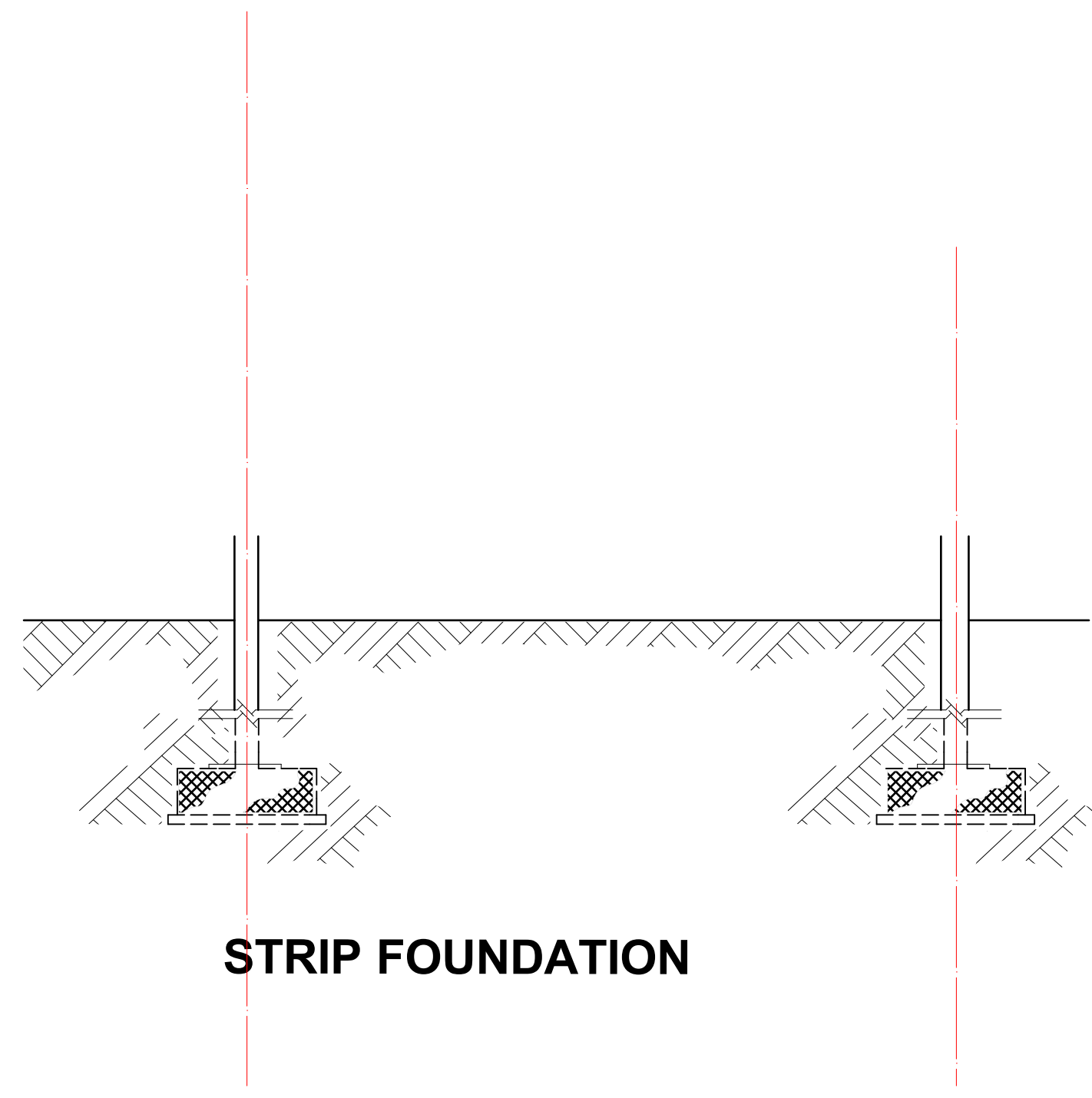

STRIP FOUNDATION

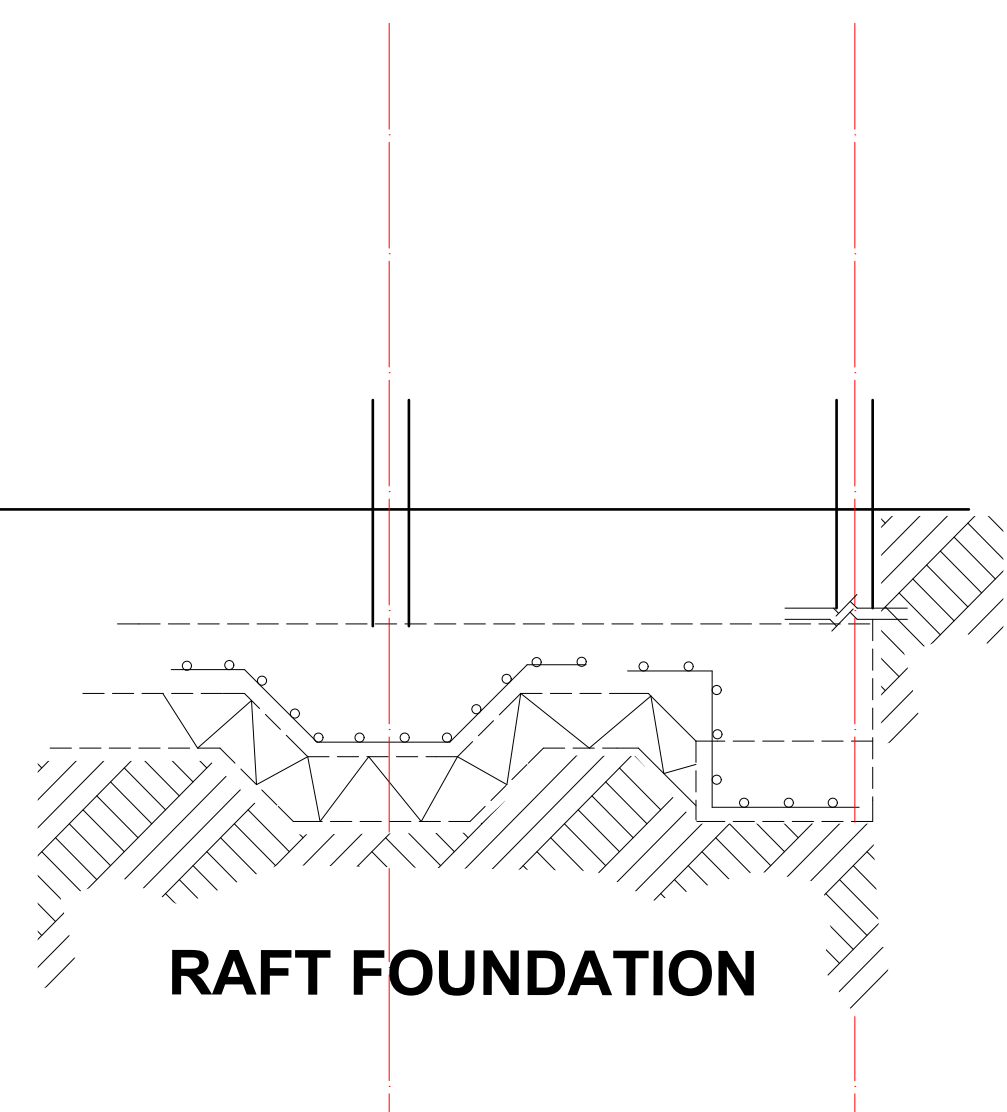

RAFT FOUNDATION

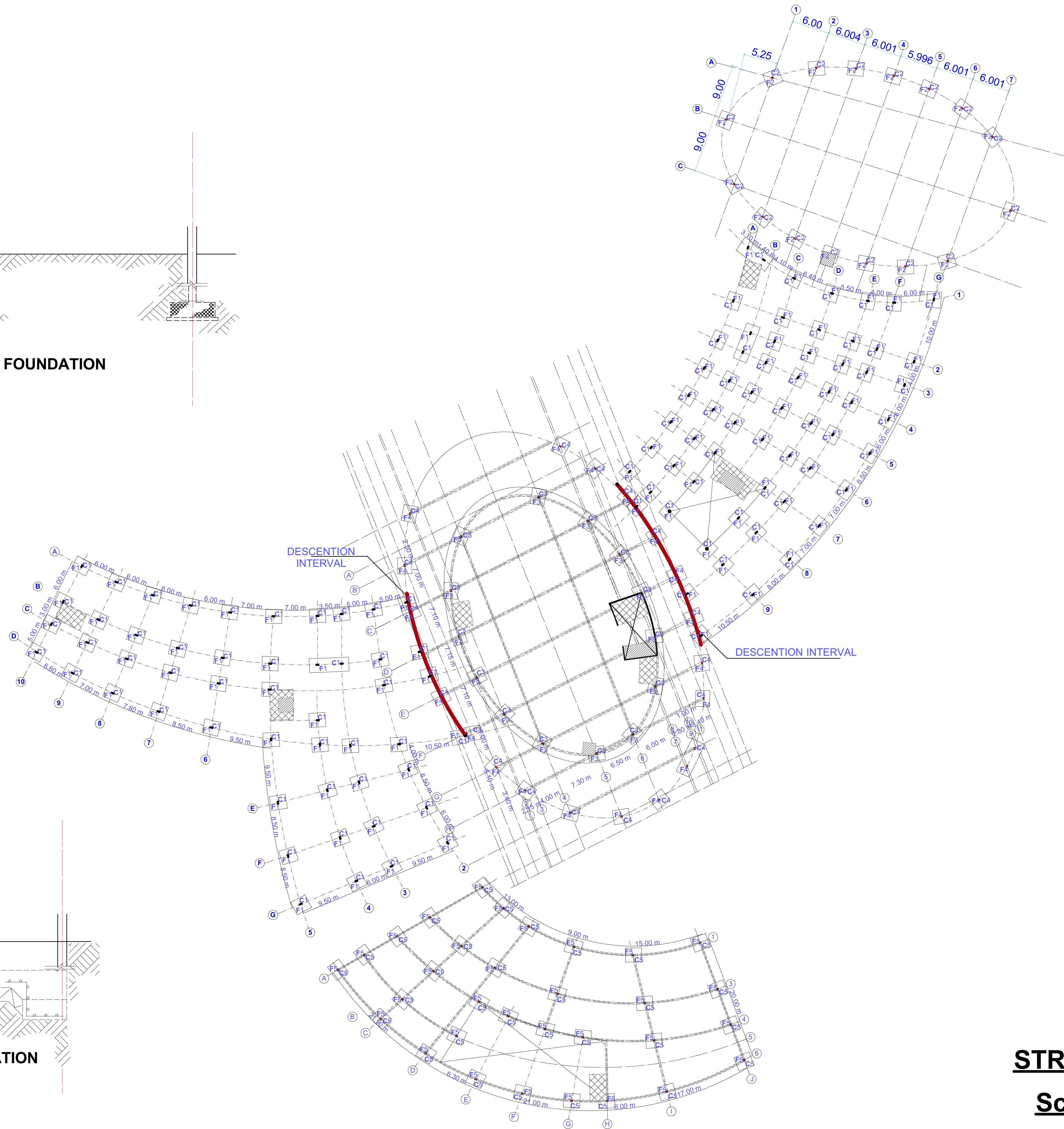

Remarks:

All Dimensions in metric units

FOUNDATIONS :

- F1 STRIP FOUNDATION 2.5 * 2.5m
- F2 STRIP FOUNDATION 2*2*2m
- F3 RAFT FOUNDATION
- F4 STRIP FOUNDATION 2*2*2m
- F5 STRIP FOUNDATION 2*2*2m

COLUMNS :

- C1 R.C.COLUMN 25 * 50 cm
- C2 STEEL COLUMN 25 * 25 cm
- C3 STEEL COLUMN 30 * 30 cm
- C4 STEEL COLUMN 25 * 25 cm
- C5 STEEL COLUMN 25 * 25 cm

STRUCTURAL PLAN

Sudan University of Science & Technology
College of Architecture & Planning

5th Year

Sudanese Residency For communication Company's

Designed By :
Nazik Hassan Mohammed
Supervision:
T. NAGWA ALMOFTI

STRUCTURAL PLAN

Scale : 1:300