

PART PLANS & PART SECTIONS

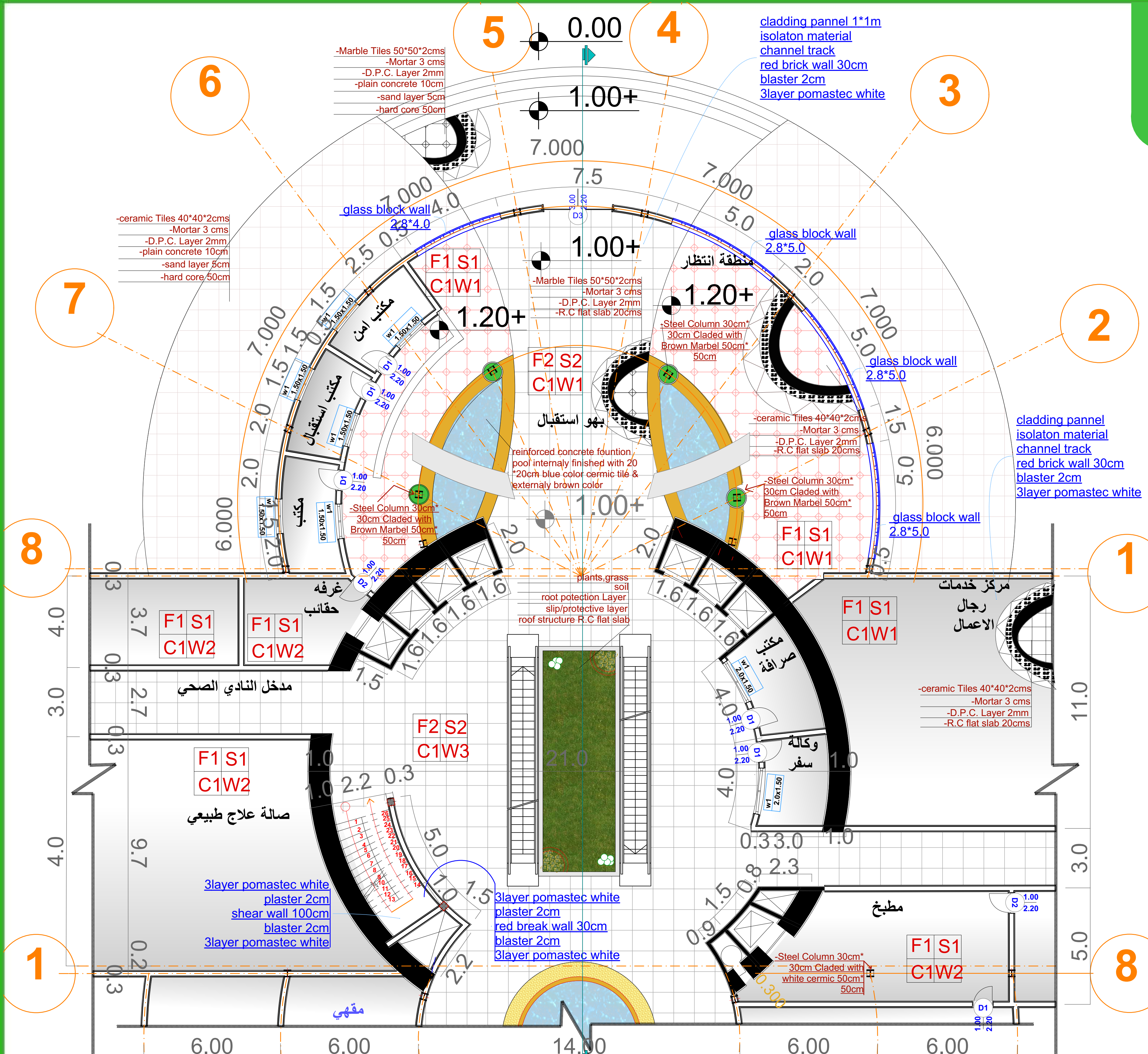

foyer part plan-scale 1:100

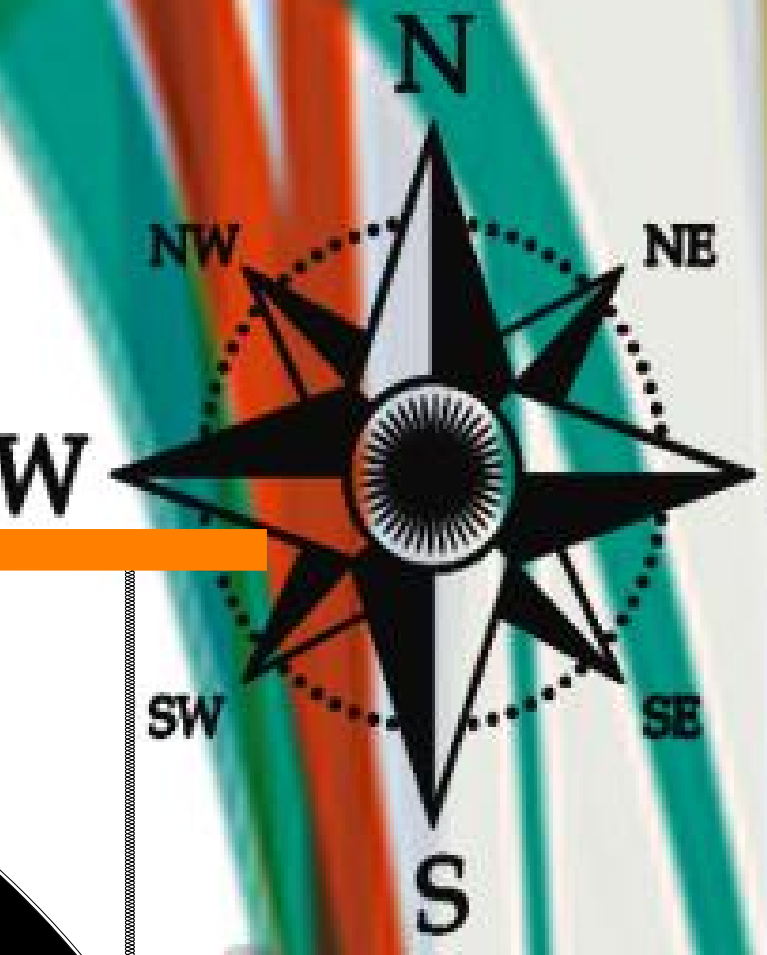
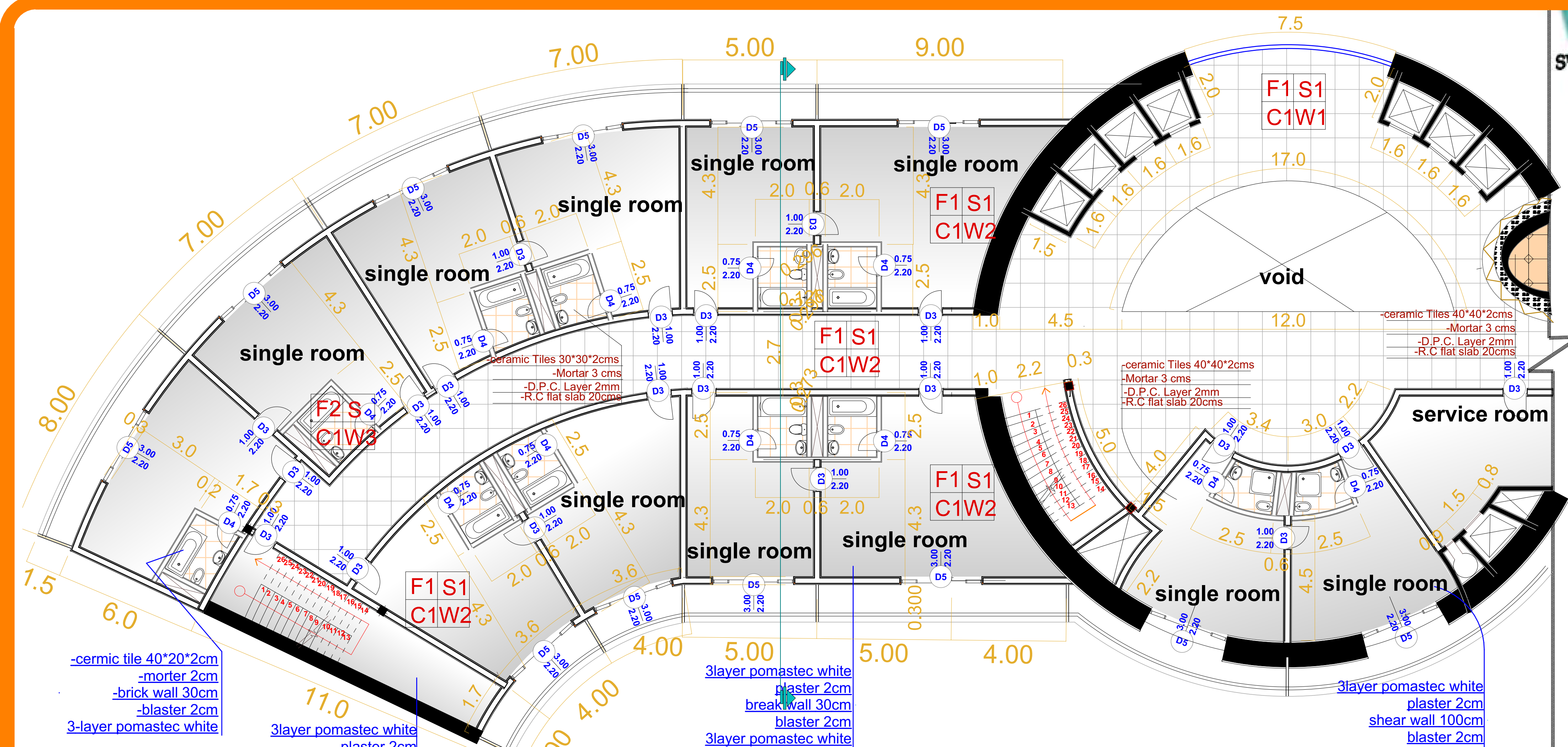

rooms part plan-scale 1:100

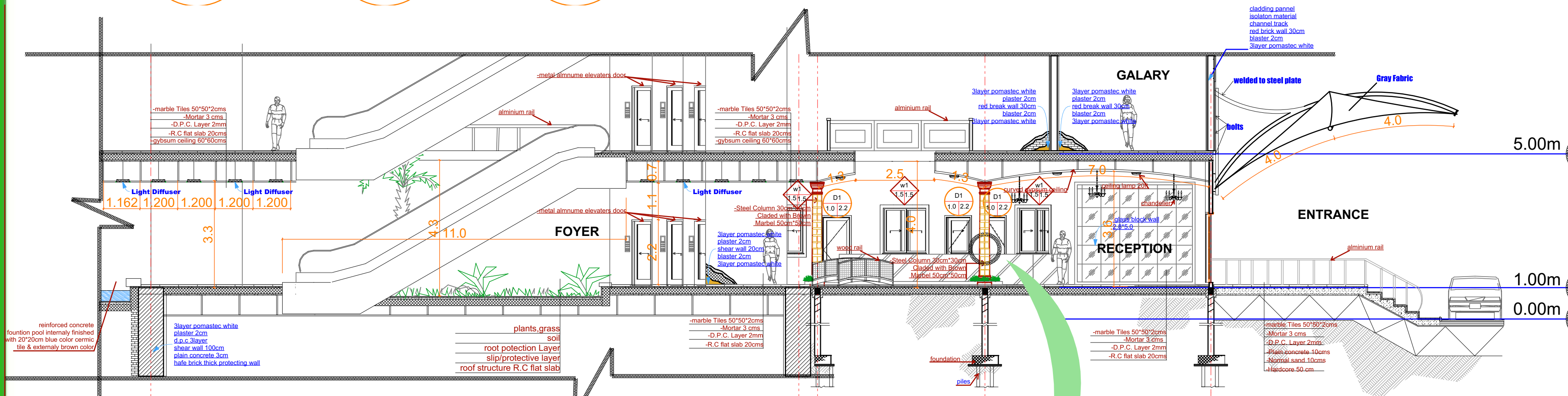

FOYER PART SECTION

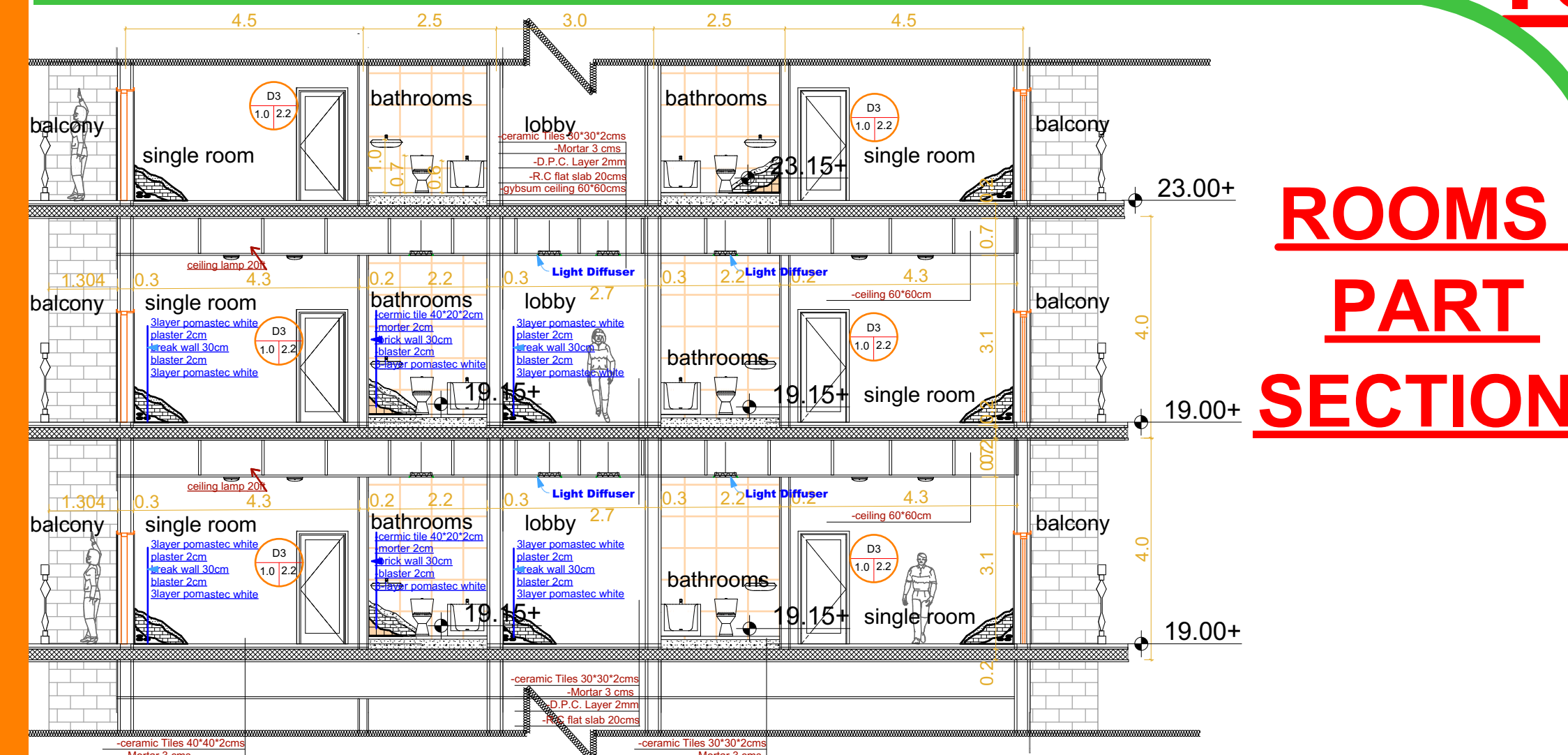

ROOMS PART SECTION

key plan

symbol	description	using
floor		
F1	-ceramic Tiles 40*40*2cms -Mortar 3 cms -D.P.C. Layer 2mm -R.C flat slab 20cms	at waiting area,shops, rooms,offices
F2	-Marble Tiles 50*50*2cms -Mortar 3 cms -D.P.C. Layer 2mm -R.C flat slab 20cms	at lobbys ,resepion, foyer
skirting		
S1	-ceramic Tiles 40*5*2cms -Mortar 2 cms -D.P.C. Layer 2mm -brick wall 30cm	at waiting area,shops, rooms,offices
S2	-Marble Tiles 50*5*2cms -Mortar 2cms -D.P.C. Layer 2mm -brick wall 30cm	at lobbys ,resepion, foyer
ceiling		
C1	-gypsum board 60*60cm -plaster 2cms -R.C flat slab 20cms	at the core
wall		
W1	-cladding pannel 1*1m -isolaton material -channel track -brick wall 30cm -blaster 2cm -3-layer pomastec white	at entrance
W2	-3-layer pomastec white -plaster 2cm -break wall 30cm -3-layer pomastec white	shops, rooms, offices
W3	-plaster 2cm -shear wall 100cm -blaster 2cm -3-layer pomastec white	at the core
doors & windows		
symbol description using		
D1	one glass leaf door	glass sash & aluminium frame
D2	one metal leaf door	aluminium sash & frame
D3	exterior double sliding door	glass sash & aluminium frame
W1	2sash-sliding window	glass sash & almunium frame

ENTRANCE PRESEPECTIVE

structural system:concrete frame
SCALE (1:300)

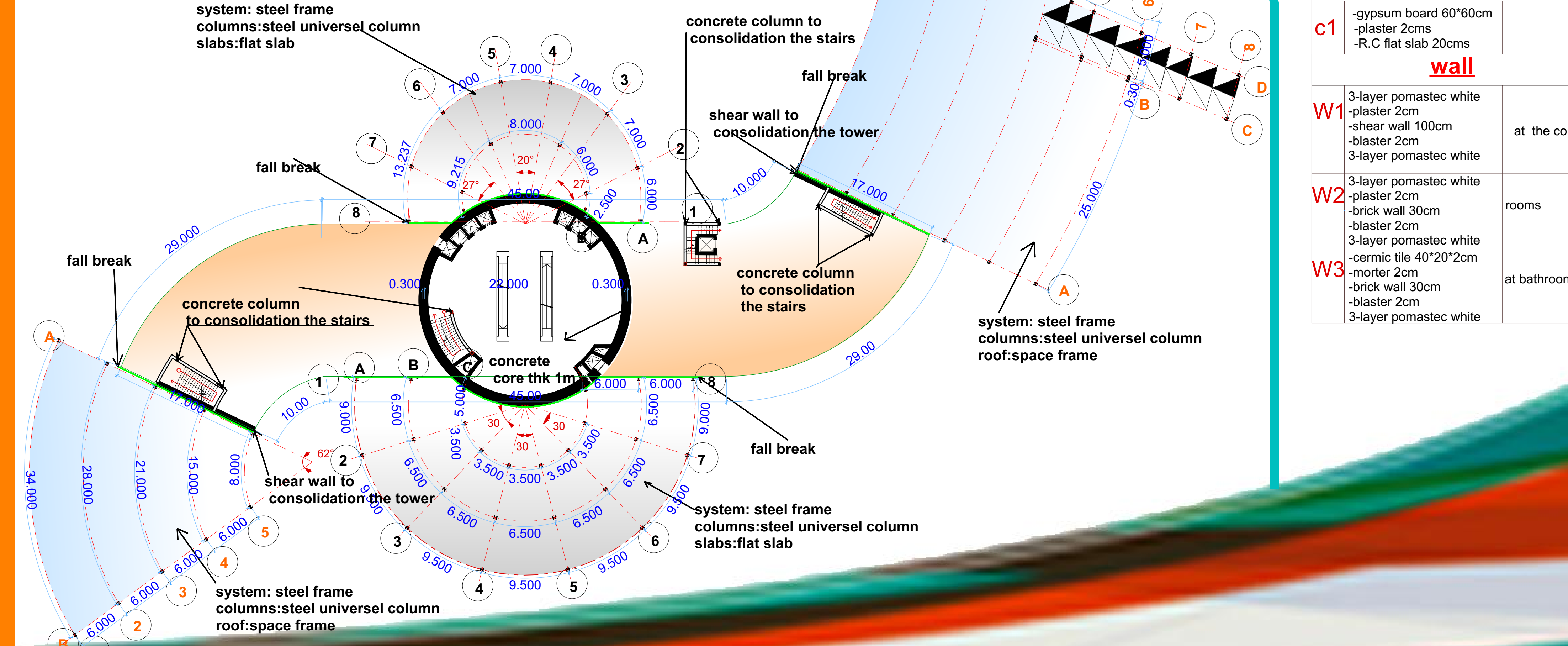

key plan

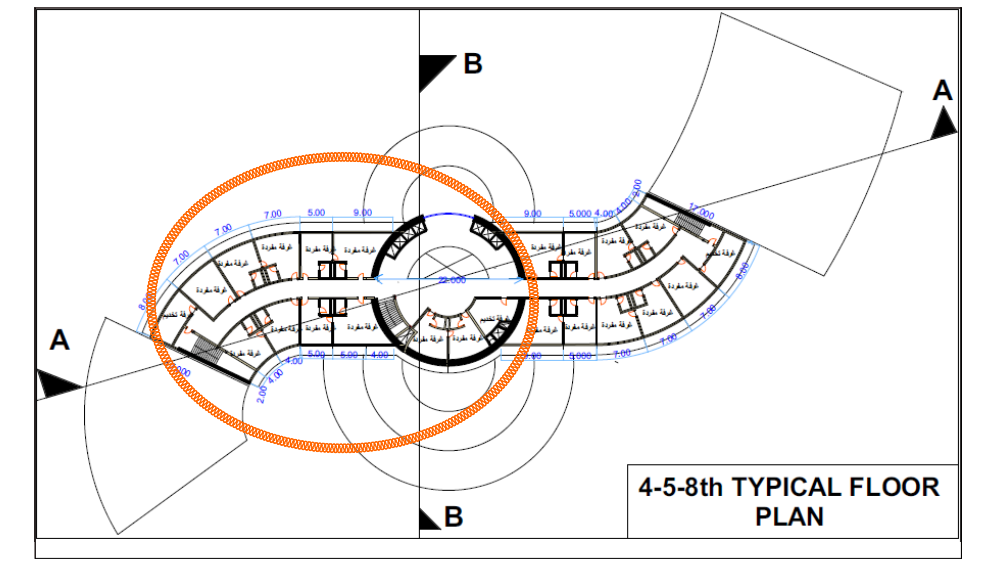

doors & windows

symbol	description	using	dimention
D5	sliding door with 2 side lights	glass sash & wood frame	2.2*3.0
D4	one wood leaf door	wood sash & frame	2.2*0.75
D3	one wood leaf door	wood sash & frame	2.2*1.0

symbol	description	using
floor		
F1	-ceramic Tiles 40*40*2cms -Mortar 3 cms -D.P.C. Layer 2mm -R.C flat slab 20cms	at the core rooms
F2	-ceramic Tiles 30*30*2cms -Mortar 3 cms -D.P.C. Layer 2mm -R.C flat slab 20cms	at bathrooms
skirting		
S1	-ceramic Tiles 40*5*2cms -Mortar 2 cms -D.P.C. Layer 2mm -brick wall 30cm	at lobbys ,core(foyer), rooms
ceiling		
C1	-gypsum board 60*60cm -plaster 2cms -R.C flat slab 20cms	
wall		
W1	-3-layer pomastec white -plaster 2cm -shear wall 100cm -blaster 2cm -3-layer pomastec white	at the core
W2	-3-layer pomastec white -plaster 2cm -brick wall 30cm -blaster 2cm -3-layer pomastec white	rooms
W3	-3-layer pomastec white -morter 2cm -brick wall 30cm -blaster 2cm -3-layer pomastec white	at bathrooms