

- A**
 - * Concrete tiles 60*60*3cm
 - *Mortar C/S 5 cm thick 1:8 mixed
 - 3* D.P.C layers, insulation materia
 - *Reinforced concrete slab 20cm
 - *False ceiling from Gypsum 60*60*2cm
- B**
 - *Sliver Aluminium steel 1.00*1.00*.25cm
 - *Insulation material membrane type
 - * Rafter from steel C section
 - *False ceiling roof 50*50*.25cm
- C**
 - *Normal sand with hardcore 20cm
 - *Lightweight concrete 10cm
 - *D.p.c 1 layer membrane sheet
 - *Mortar with 5cm thickness (1:8) mixed
 - *English Grass thikness 5cm
- D**
 - *Normal sand with hardcore 20cm
 - *Lightweight concrete 10cm
 - *D.p.c 1 layer membrane sheet
 - *Mortar with 5cm thickness (1:8) mixed
 - *Pavement Brick15*5* 5cm
- E**
 - *Normal sand with hardcore 20cm
 - *Lightweight concrete 10cm
 - *D.p.c 1 layer membrane sheet
 - *Mortar with 5cm thickness (1:8) mixed
 - *Pavement Brick15*5* 5cm

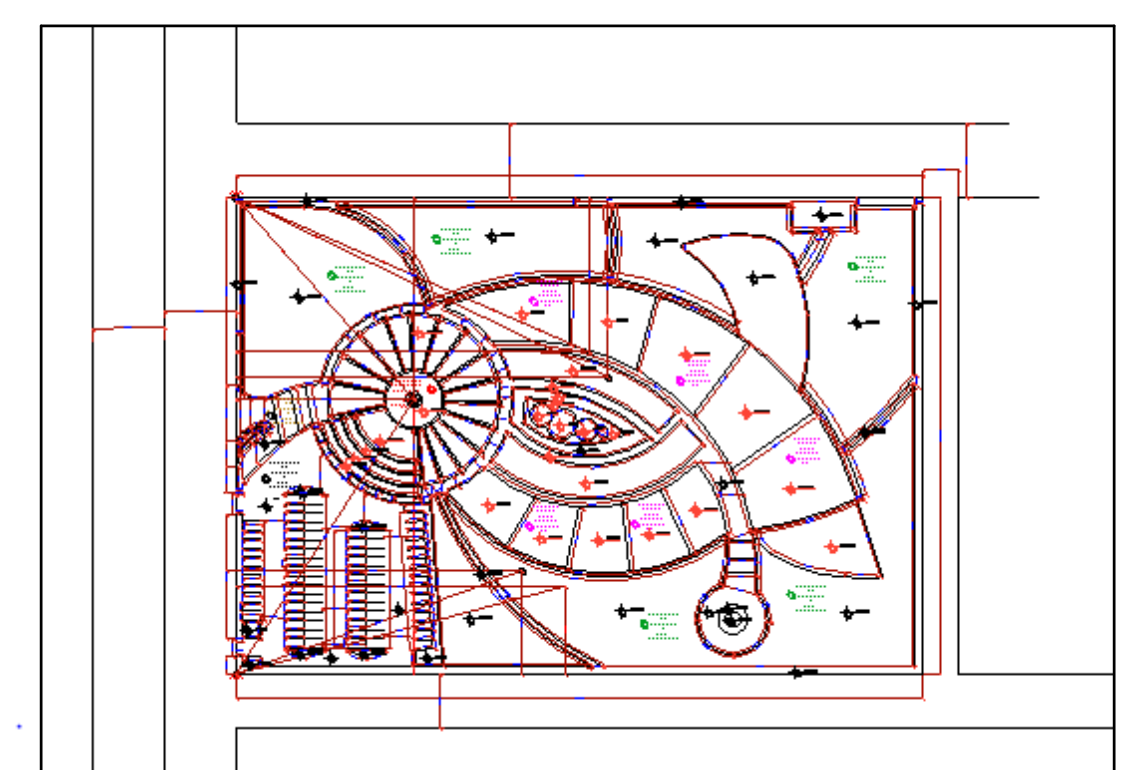

Sudan University of Science and Technology
 College of Engineering
 Architecture Department
 Fifth Year Semster 10 (technical solution)
Riham Mohammed Alnasri
 Supervisor: Dr.Awad Sa'ad
 Measurement & Treatment Site
 SCALE 1:500